

BOM/Parts/Pos			
Part #	Material	Qty	POS
78FPPL_R3	PA66-GF15/STEEL	1	4.1
78BPL-V2S_R3	PP_GF30	1	4.2
68SEC-S	PA66-GF30	4	5
78SELOCK	PA66-GF30	1	6
58LIP_2	EPDM	1	7
78HP160	SS_316L	1	8
68SEC45	PA6-GF30	2	8.1
78PP_B2	PP_GF30	1	10.1
78NUT15Z	PA	1	10.2
78UN_S15	PVC	1	10.3
78UN_E321		1	10.4

* PP/GF can be replaced by HIPS/GF without further notice

O-Rings / Endplate				
A	O-Ring	32.92x3.5	1	EPDM
B/C	O-Ring	41.28x3.5	1	EPDM
D	O-Ring	49.26x1.8	1	EPDM

Knappe Composites			
Endplate ASSY Frontport 18EPBW-V2s	Mat.:		
	DATUM:	REV:	:
	28.06.06	2	
Name	18EPBW-V2S_R2CUST	Page	1/1

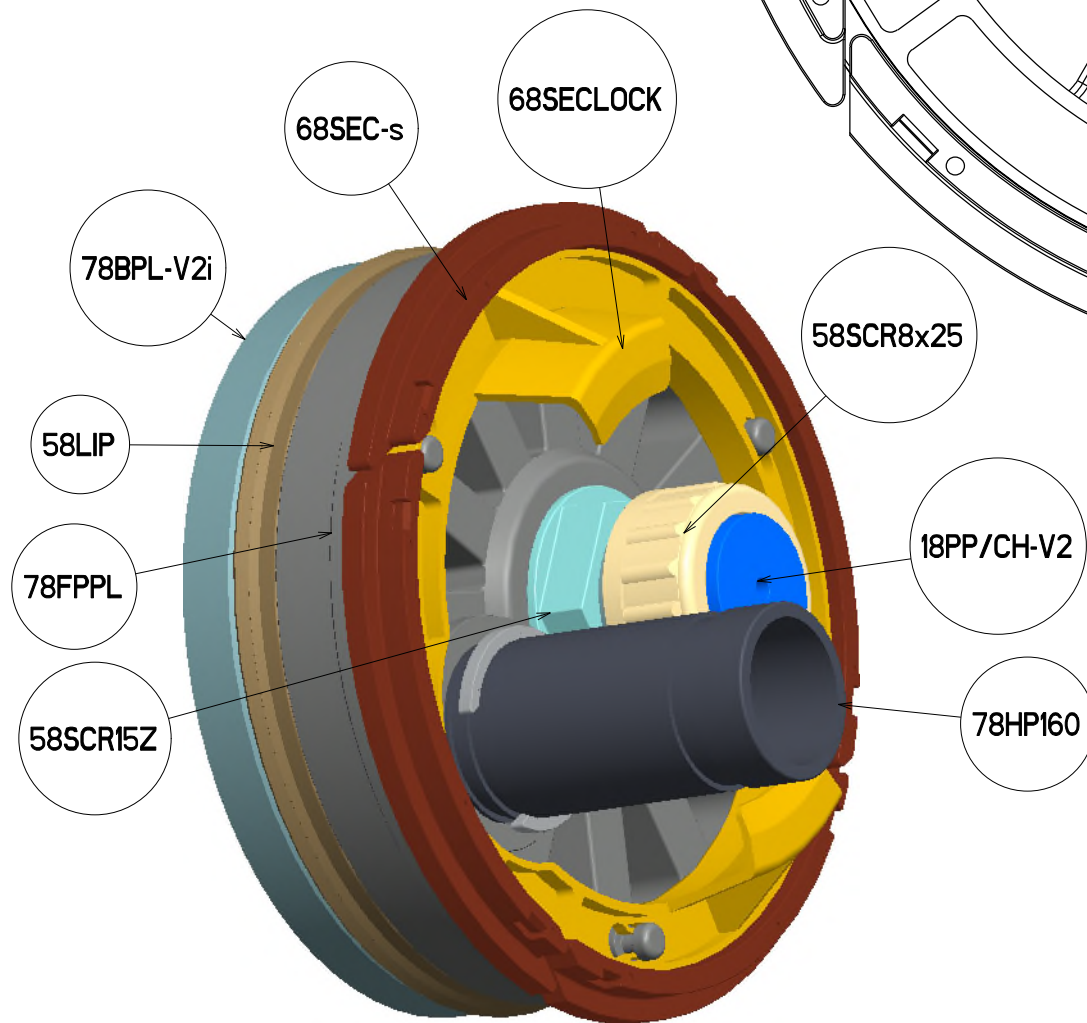
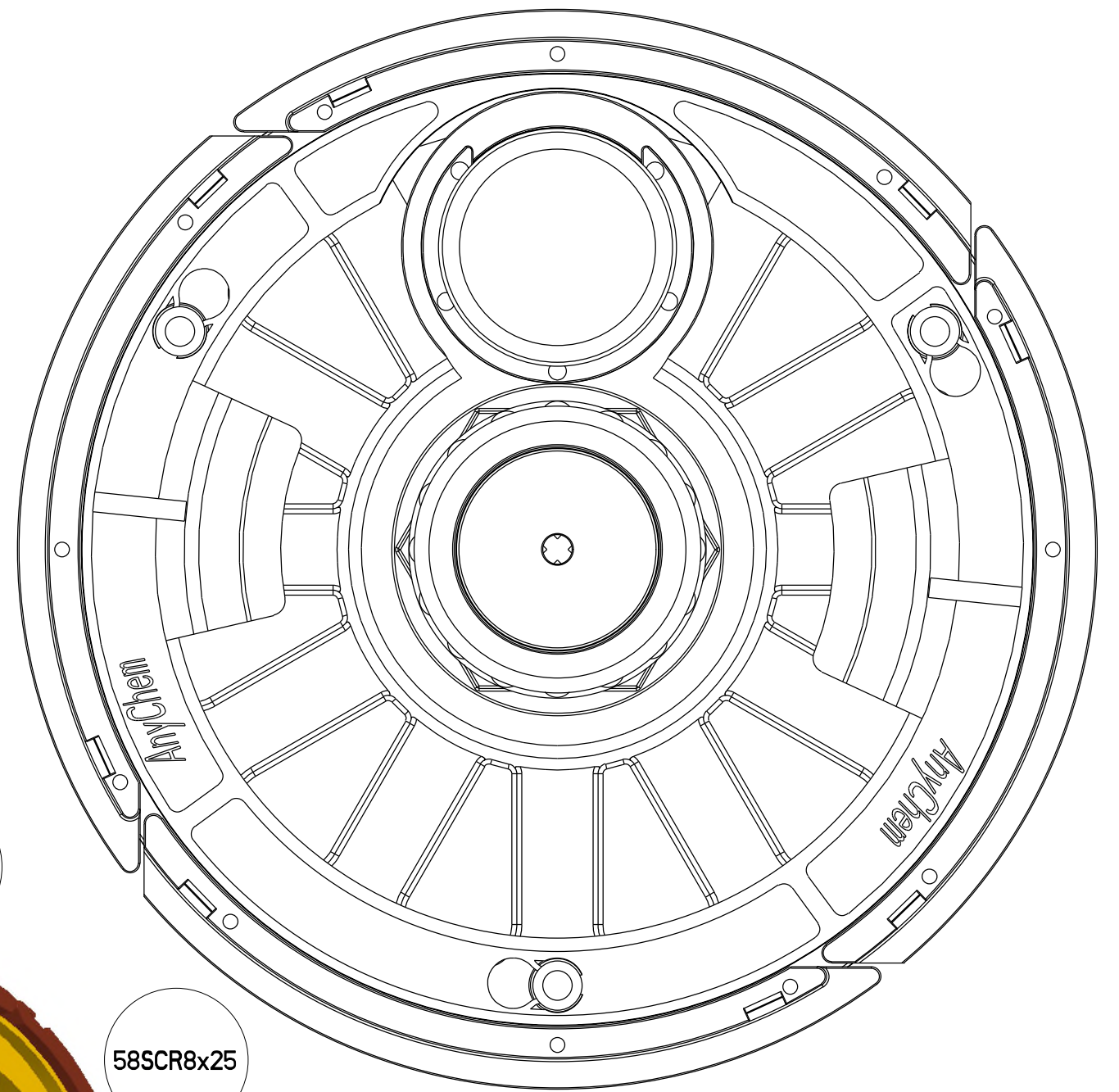
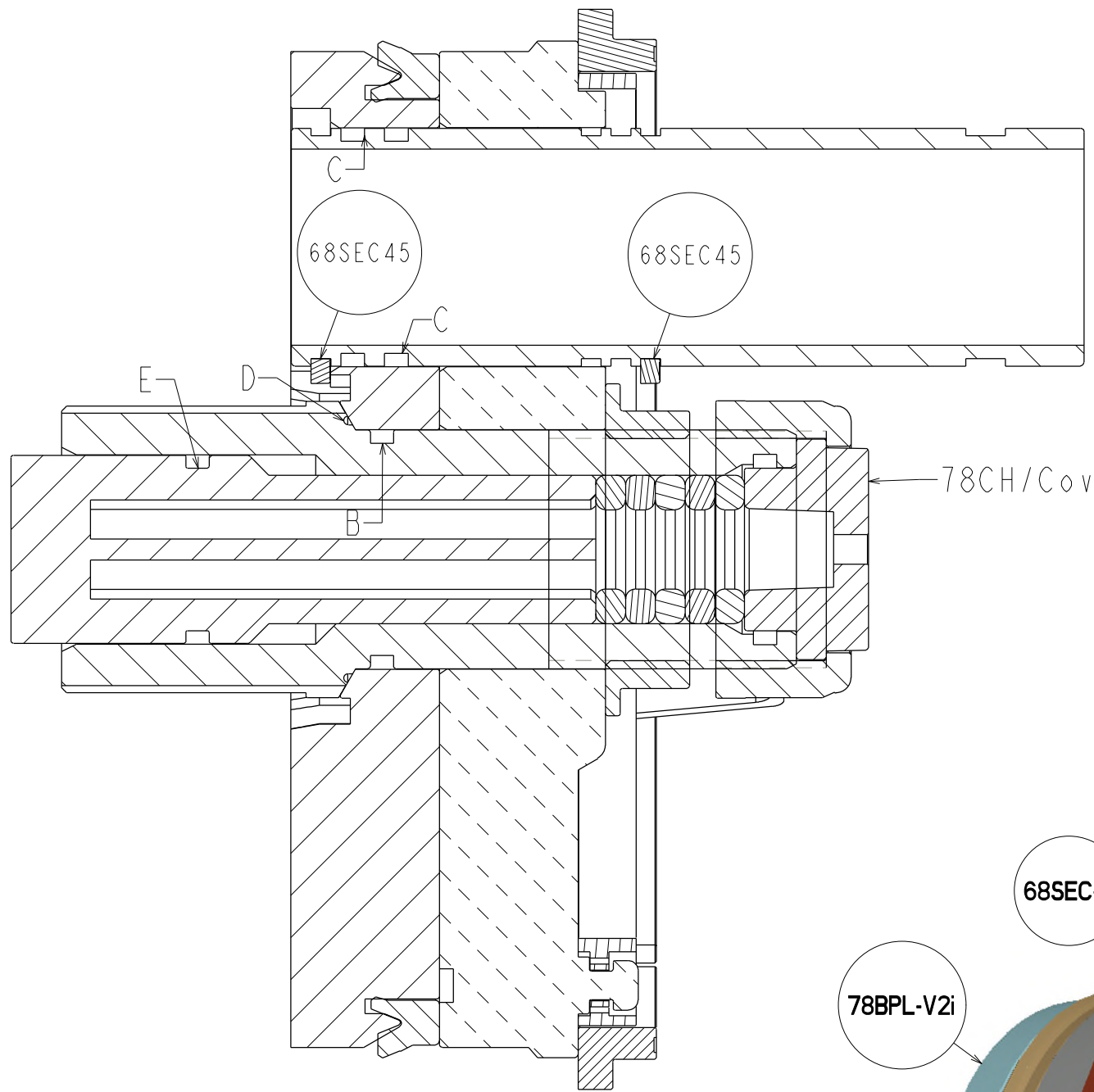

BOM/Parts/Pos			
Part #	Material	Qty	POS
78FPPL_R3	PA66-GF15/STEEL	1	4.1
78BPL-V2S_R3	PP_GF30	1	4.2
68SEC-S	PA66-GF30	4	5
78SECLOCK	PA66-GF30	1	6
58LIP_2	EPDM	1	7
78HP160	SS_316L	1	8
68SEC45	PA6-GF30	2	8.1
78CH-COV	PVC	1	9.5
78CH-ELAST	TPV241-80	5	9.5
78PP_CH-V2	PVC	1	9.5
78PP_B2	PP_GF30	1	10.1
78NUT15Z	PA	1	10.2
78UN_S15	PVC	1	10.3

* PP/GF can be replaced by HIPS/GF without further notice

O-Rings / Endplate				
B	O-Ring	41.28x3.5	1	EPDM
C	O-Ring	41.28x3.5	1	EPDM
D	O-Ring	49.26x1.8	1	EPDM
E	O-Ring	32.92x3.5	1	EPDM

Knappe Composites			
Endplate ASSY Frontport closed 18EPBW-V2s/C		Mat.: DATUM: 28.06.06	REV: 2
Name	18EPBW-V2S_C-R2CUST	Page	1/1